



TECHNICAL DATA / FEATURES

- dimensions: $\phi 90 \times 83$
- light functions: fog light
- function markings: B
- reference mark: -
- source of light: H11
- maximum power: 55W
- nominal voltage: 12V DC
- optics: FF
- IP rating: IP66
- housing's material: plastic
- housing's colour: black
- lens' material: glass
- lens' colour: clear
- mounting: 4 bolts
- built-in connectors: -



DEDICATED APPLICATION

RENAULT

- SCÉNIC
- II (JM0/1_) from 06.2003
- III (JZ0/1_) from 02.2009
- KANGOO
- Express (FW0/1_) from 02.2008
- KANGOO (KW0/1_) from 02.2008
- LAGUNA
- II (BG0/1_) from 03.2001
- II Grandtour (KG0/1_) from 03.2001
- III Coupe (DT0/1) from 10.2007
- III (BT0/1) from 10.2007
- III Grandtour (KT0/1) from 10.2007
- MEGANE
- II (BM0/1_, CM0/1_) from 11.2002
- II CC (EM0/1_) from 09.2003
- II Grandtour (KM0/1_) from 08.2003
- II Sedan (LM0/1_) from 09.2003
- III Coupe (DZ0_) from 11.2008
- III Hatchback (BZ0_) from 11.2008
- III Grandtourer (KZ0/1) from 11.08
- III Sedan from 06.2009
- TWINGO (CN0_) from 03.2007
- FLUENCE from 02.2010
- GRAND SCÉNIC
- II (JM0/1_) from 04.2004
- III (JZ0/1_) from 02.2009
- MASTER
- II (JD/ND) from 09.2000
- II (FD/ED/HD/UD) from 09.2000
- III (JD) from 10.2003
- III (FD/ED/HD/UD) from 10.2003
- TRAFIC
- II (JL) from 05.2003
- LOGAN (LS_) from 09.2004
- MCV (KS_) from 04.2007

DACIA

- LOGAN
- EXPRESS from 03.2009
- MCV from 02.2007
- LOGAN from 09.2004
- LOGAN Pick-up from 03.2008
- SANDERO from 06.2008
- SOLENZA from 02.2003

PEUGEOT

- 107 from 06.2005
- 207
- (WA_, WC_) from 02.2006
- CC (WD_) from 02.2007
- SW (WK_) from 02.2007

PEUGEOT

- 307
- (3A/C) from 08.2000
- Break (3E) from 03.2002
- CC (3B) from 10.2003
- SW (3H) from 03.2002
- 407 Coupe (6C_) from 10.2005
- 607 (9D, 9U) from 02.2000
- CITROËN**
- C4
- (LC_) from 11.2004
- Coupe (LA_) from 11.2004
- Picasso (UD_) from 02.2007
- Grand Picasso (UA_) from 10.2006
- C5
- (RC_) from 09.2004
- Break (DE_) 06.2001-08.2004
- Break (RE_) from 09.2004
- C6 (TD_) from 09.2005
- XSARA PICASSO (N68) from 12.1999

SUZUKI

- ALTO V (GF) from 01.2009
- GRAND VITARA (JB) from 04.2005
- SPLASH from 01.2008
- SWIFT III (SG) from 02.2005

OPEL

- AGILA B from 09.2007
- ASTRA
- G Coupe (F07_) 03.2000-05.2005
- G Hatchback (F48_, F08_) from 02.1998
- G Cabrio 03.2002-10.2005
- G Caravan (F35_) 02.1998-07.2004
- G (F70) from 01.99-04.05
- G Sedan (F69_) 09.98-01.05
- H GTC from 08.2005
- MERIVA from 09.2005
- SIGNUM from 05.2003
- TIGRA TwinTop from 06.2004
- VECTRA
- C GTS from 08.2002
- C Caravan from 10.2003
- C from 04.2002
- ZAFIRA from 07.2005
- (F75_) 09.2001-06.2005

FORD

- FIESTA
- V (JH_, JD_) from 11.2001
- VI from 10.2008
- FOCUS
- II (DA_) from 11.2004
- II CC from 10.2006
- II Sedan (DA_) from 04.2005
- II Turnier (DAW_) from 11.2004

FORD

- FUSION (JU_) from 08.2002
- TOURNEO CONNECT from 06.2002
- TRANSIT
- CONNECT (P65_, P70_, P80_) from 06.2002
- TOURNEO from 07.2006

NISSAN

- NAVARA (D40) from 07.2005
- NOTE (E11) from 03.2006
- PATHFINDER (R51) from 03.2005
- PIXO (UA0) from 06.2009

JAGUAR

- S-TYPE (CCX) from 01.1999
- Estate from 11.2003
- S-TYPE (CCX) from 01.1999

VAUXHALL

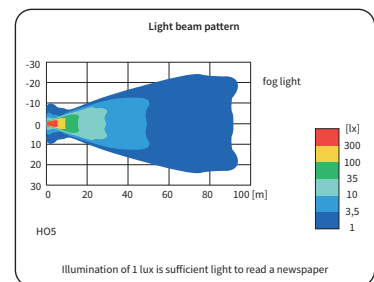
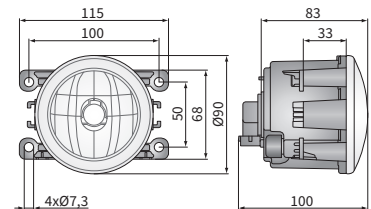

Cat. number	Tyc Catal. No.	Valeo Catal. No.	Homologation code	Light functions		Accessories	bulb H11 12V	Side	right	left	Application	dedicated	Packaging / pc	carton box
				fog light										
H05.46100	19-5785-11-2	088358	061	✓				✓	✓		A		1	