



TECHNICAL DATA / FEATURES

dimensions: 192x133x126, 192x133x123
 light functions: passing, driving, position
 function markings: C/R, A, HC/R
 traffic: right-hand
 reference mark: 7.5, 17.5
 source of light: R2, T4W, H4
 maximum power: 55/50W, 4W, 75/70W
 nominal voltage: 12V-24V DC
 optics: standard
 IP rating: IP54
 housing's material: metal
 lens' material: glass
 built-in connectors: -



ADDITIONAL INFORMATION

Particularly recommended for tractors and slow-moving vehicles.

To be mounted in factory designed locations or in the front bumper recesses.

Useful parts while installing:

- main bulb gasket - cat. No. A.05820
- position light bulb holder - cat. No. A.05921
- main bulb mounting block - cat. No. A.07128

Dedicated application for tractors:

A - New Holland:

- serie 56S: 55-56S, 65-56S, 75-56S
- serie 66S: 60-66S, 70-66S, 80-66S.

B - Fiat:

- serie classic: 446, 466, 566, 570, 580, 666, 670, 680, 766, 780, 880, 980, 1180, 1280, 1380, 1580, 1880
- serie 46: 65-46,
- serie 56: 65-56, 70-56
- serie 66: 55-66, 60-66, 65-66, 70-66, 80-66
- serie 90: 55-90, 60-90, 70-90, 80-90, 85-90, 90-90, 95-90, 100-90, 110-90, 115-90, 130-90, 140-90, 160-90, 180-90
- serie 93: 60-93, 65-93, 72-93, 82-93
- serie 94: 60-94.

DIMENSIONS

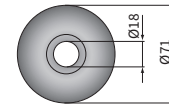
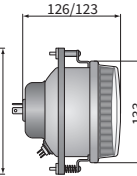
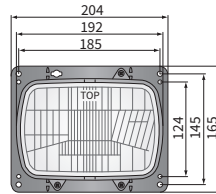

A.05820

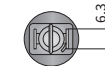
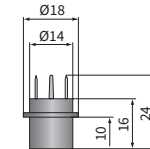

A.05921

Cat. number	Homologation code	Light functions			Type	R2	H4	Reference mark		Accessories		Side		Application		Packaging / pc	
		passing	driving	position				7.5	17.5	mounting plate	bulb gasket	right	left	dedicated	carton box		
RE.27607	029	✓	✓		✓		✓		✓	✓	✓	✓	✓	B		1	
RE.27608	029	✓	✓	✓	✓		✓		✓	✓	✓	✓	✓	A		1	
RE.27708	030	✓	✓	✓		✓			✓	✓	✓	✓	✓			1	